

**INBOARD**

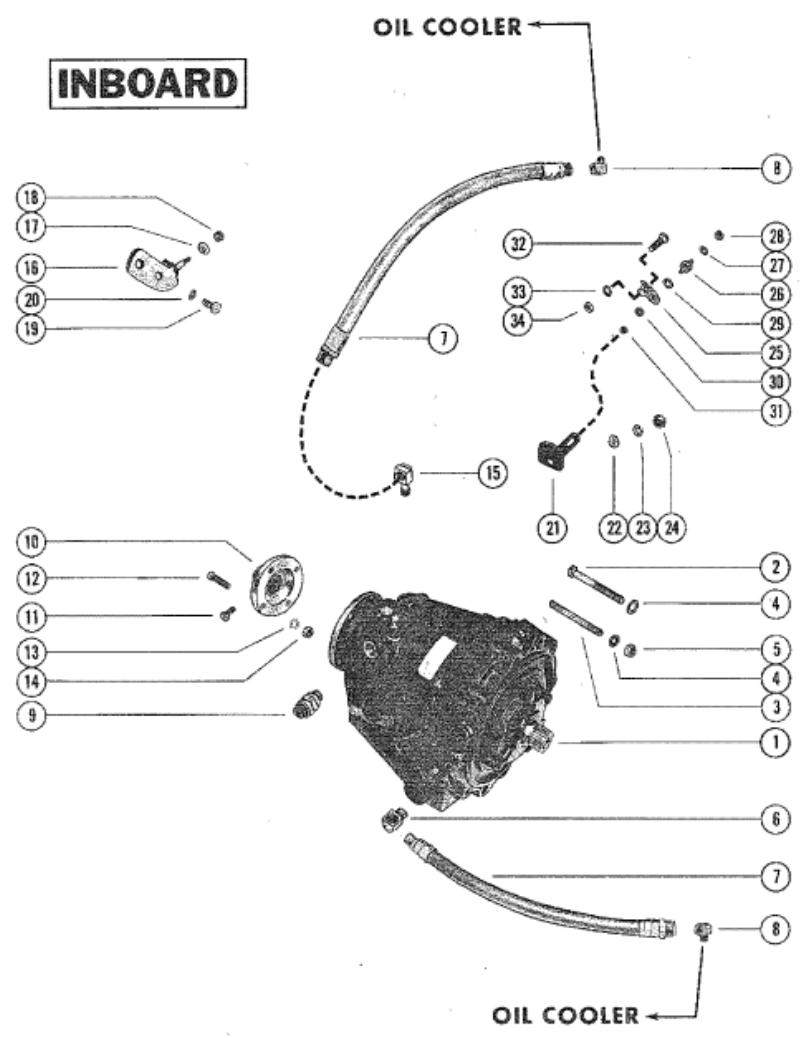

Parts List						
Ref	Class	Part	Description	Qty	Comment	Footnote
1		47805	TRANSMISSION (DIRECT DRIVE)	1,...		
1		47806	TRANSMISSION (1.523:1 REDUC	,1,...		
1		47807	TRANSMISSION (1.909:1 REDUC	,,1,...		
1		47808	TRANSMISSION (2.57:1 REDUCT	,,,1,		
1		47809	TRANSMISSION (2.909:1 REDUC	,,,,1		
2	10	47724	SCREW, TRANSMISSION TO ENI	4,...		
2	10	47724	SCREW, TRANSMISSION TO ENI	,6,6,6,E		
3	16	57921	STUD, TRANSMISSION TO ENGI	2,...		
4	13	32993	LOCKWASHER, TRANSMISSION	6,6,6,6,		
5	11	22024	NUT, TRANSMISSION STUD	2,...		
6	22	47629	ELBOW, HOSE TO TRANSMISSIC	1,1,1,1,		
7	32	47516 11	HOSE, TRANSMISSION TO OIL C	1,...		
7	32	47516 12	HOSE, TRANSMISSION TO OIL C	,1,1,1,1		
7	32	47516 6	HOSE, TRANSMISSION TO OIL C	1,1,1,1,		
8	22	63835	ELBOW, HOSE TO OIL COOLER	,1,1,1,1		
9		47613	SWITCH, NEUTRAL SAFETY	1,1,1,1,		
10		48381A 1	FLANGE ASSEMBLY (1") SEE NO	OPT,OI		
10		48382A 1	FLANGE ASSEMBLY (1 1/8") SEE	OPT,OI		
10		48383A 1	FLANGE ASSEMBLY (1 1/4") SEE	OPT,OI		
10		48384A 1	FLANGE ASSEMBLY (1 3/8") SEE	OPT,OI		
10		48385A 1	FLANGE ASSEMBLY (1 1/2") SEE	OPT,OI		
10		48386A 1	FLANGE ASSEMBLY (1") SEE NO	,...OPT,		
10		48387A 1	FLANGE ASSEMBLY (1 1/8") SEE	,...OPT,		
10		48388A 1	FLANGE ASSEMBLY (1 1/4") SEE	,...OPT,		
10		48389A 1	FLANGE ASSEMBLY (1 3/8") SEE	,...OPT,		
10		48390A 1	FLANGE ASSEMBLY (1 1/2") SEE	,...OPT,		
11	10	60168	SCREW, FLANGE TO PROPELL	2,2,2,		
11	10	60171	SCREW, FLANGE TO PROPELL	,,2,2		
11	10	60170	SCREW, FLANGE TO PROPELL	,,2,2		
11	10	60169	SCREW, FLANGE TO PROPELL	2,2,2,		
12	10	37909	SCREW, FLANGE TO TRANSMI	4,4,4,		
13	13	35048	LOCKWASHER, TRANSMISSIOI	4,4,4,		
14	11	24883	NUT, TRANSMISSION FLANGE	,4,4,4,4		
15	22	63824	ELBOW, HOSE TO TRANSMISSIC	1,1,1,1,		
16		48648	BRACKET, SHIFT CALBE (SERIAL	1,1,1,1,		
16		63815A 1	BRACKET, SHIFT CABLE (SERIAL	1,1,1,1,		
17	12	56881	WASHER, SHIFT CABLE TO BRAI	1,1,1,1,		
18	11	46438	NUT, SHIFT CABLE TO BRACKET	1,1,1,1,		
19	10	22469	SCREW, BRACKET TO TRANSMI	2,2,2,2,		
20	13	26393	LOCKWASHER, BRACKET SCREW	2,2,2,2,		
21		48515	LEVER, SHIFT TRANSMISSION	1,1,1,1,		